

IDENTIFICATION

MORPHOACCESS® SIGMA SERIES

ACCESS CONTROL AND TIME & ATTENDANCE FINGERPRINT STATION

Compatible with
Morpho and biOScrypt®
existing installations



STILL THE WORLD'S BEST IN BIOMETRICS... AND SO MUCH MORE!

- Time & Attendance features
- Tablet-like user experience
- Videophone function
- Anti-fraud: fake finger & face detection, duress finger
- Full set of contactless technologies including NFC
- IP 65 Weather Resistant design available

... and fast 1:100 000 identification!

MORPHOACCESS® SIGMA SERIES

ACCESS CONTROL AND TIME & ATTENDANCE FINGERPRINT STATION

United in a team whose experience and skill level have no equivalent in the industry, experts from Morpho and Bioscrypt join forces to design the best of breed fingerprint identification terminal.

Tailored for both Access Control and Time & Attendance applications, the MorphoAccess® SIGMA (MA SIGMA) Series implements no fewer than 20 patents to master biometric identification and deliver a host of additional features, together with a refined and enjoyable user experience.



Ultra-secure

The World's most accurate fingerprint technology is further enhanced with additional anti-fraud and anti-"buddy punching" features:

- Face detection and picture logging
- Fake finger detection
- Duress finger
- White/Black lists



Fresh, intuitive, flexible User Interface

The MA SIGMA Series implements the design cues from today's most intuitive consumer electronics, for fast user adoption:

- 5" WVGA color touch-screen highlighting a sophisticated Graphic User Interface
- Seamless on-device administration
- Extensive customization capabilities: use your own content! (corporate video, audio messages, wallpapers etc.)

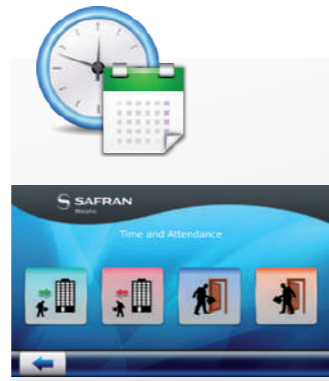

Time & Attendance ready

Increase your workforce management efficiency with:

- Touch-screen Time Clock, featuring 16 programmable function keys
- Access time slots and holidays scheduling
- Accurate punch records (up to 1 Million logs storage capacity)
- Real-time employee notifications
- Job Code management

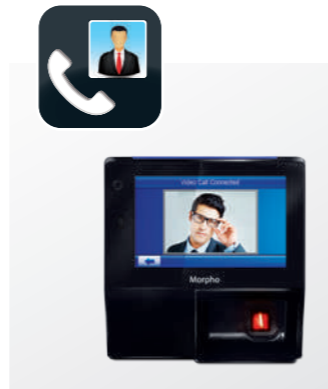
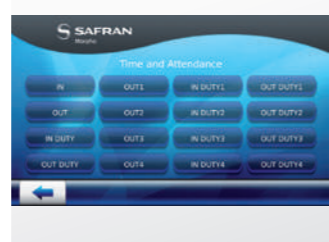

Videophone function

- Built-in camera, speaker and microphone
- Standard IP-based video and audio interface
- Use cases:
 - Call-in function: employees can quickly report a problem right from the Time Clock
 - Surveillance: the terminal can be used by security staff to get pictures remotely from the security post



World #1 Fingerprint Technology inside

- New generation Morpho algorithms (MINEX and FIPS 201 approved)
- Genuine 1:100K matching⁽¹⁾: World first in the industry
- 1:100K identification in less than 1 second (for frequent users)
- Exclusive optimizations tailored for access control
- Accuracy maintained regardless of number of users
- FBI PIV IQS certified optical sensor

⁽¹⁾ Search carried out against single 100K user database



Multiple Recognition Factors

- NFC⁽²⁾ technology support
- Full set of contactless smartcard options: Prox®, iClass®, MIFARE®, MIFARE® Plus, DESFire®
- PIN and BioPIN⁽³⁾ codes

⁽²⁾ NFC: Near Field Communication

⁽³⁾ BioPIN: alternate password solution instead of fingerprints



Easy Set-up and Maintenance

Built for the real World and designed to save time at installation and reduce maintenance costs:

- Flush mounted "quick-tilt" access
- No need for extra-cable wiring: connectors are directly pluggable on rear side
- On-device or remote IP-based set-up
- Secure USB port located on the side of the product

Morpho
bioscrypt®

Compatible with Existing Installations

Upgrade or complement your installation with MorphoAccess® SIGMA devices using:

- M2A application or MIK SDK on a Morpho network
- SecureAdmin™ application or SecureSDK™ on a Bioscrypt network

TECHNICAL SPECIFICATIONS

- CPU: ARM® Cortex™-A9 core 1GHz
- Linux Operating System
- 5" WVGA color Touch-screen, VGA Camera
- Loudspeaker & Microphone
- Audio & Video player
- FBI PIV IQS certified optical fingerprint sensor
- Contactless reader options: Prox®, iClass®, MIFARE®/MIFARE® Plus/DESFire®/NFC
- Network/Communication: Ethernet, RS485, RS422, USB (host & slave) Options: Wi-Fi, 3G cellular communication
- Internal storage capacity: 512MB Flash, 512MB RAM + μSD Card slot
 - 3000 user records (2 fingers + 1 duress each), extendable up to 100 000 with μSD Card and licenses
 - 250 000 user IDs in white list
 - 1 Million transaction logs (100 000 w/o μSD Card)
 - 1 Million face picture logs (only w/ μSD Card)
- Inputs/outputs: Wiegand In & Out (customizable up to 512 bits), Door Relay, 3 GPI (including Door monitoring), 3 GPO
- Power supply: 12V-24V DC Power over Ethernet (PoE) option
- Tamper switches
- Operating conditions:
 - Temperature: -10°C to 55°C (14°F to 131°F)
 - Humidity: 10% to 80% (non condensing)
- 2 design options: Weather Resistant (IP 65 rated) or Indoor
- Compact with slim-profile: HxWxD = 153x115x58,5 mm (6x5,9x2,3 inches)
- Ultra-light: about 470 grams (depends on variant)
- Replaceable back-up battery
- EMC/Safety standards: CE, CB, FCC, UL294
- RoHS, REAcH and WEEE compliant



INDOOR DESIGN
(UL294 CERTIFIED)

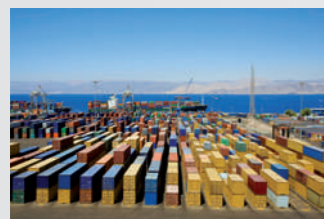

KEY MISSIONS, KEY TECHNOLOGIES, KEY TALENTS

Morpho

Phone: +33 (0)1 58 11 73 42 - Fax: 33 (0)1 58 11 25 50 - www.morpho.com - www.biometric-terminals.com
Registered Office: 11, boulevard Gallieni - 92130 Issy-les-Moulineaux - FRANCE
Société anonyme au capital de 159.876.075 euros - 440 305 282 RCS Nanterre

